

Red
Spice
Road



Function Packages

Say no to boring work functions and choose a venue where you will actually enjoy the food!

Red Spice Road's private dining rooms in the heart of Melbourne have been the venue for countless team lunches, work Christmas parties and special events such as weddings and birthdays.

redspiceroad.com



Red Spice Road



Function Menus

Wrap your mouth around taste sensation from around the continent without leaving Melbourne! From Thailand to Malaysia, China to Vietnam and everywhere in between.

Our team delivers food that will immerse your palette into the flavours of Asia.

OUR LEGEND

- S** Contains Shellfish
- G** Contains Gluten
- N** Contains Nuts
- D** Contains Dairy
- V** Vegetarian
- VG** Vegan



Lunch

Our tasting menu is designed to share. Choose from;

Any dietary requirements must be communicated 48 hours prior to the event for our team to provide replacement dishes.

Pumpkin, Mushroom, Holy Basil Salad, Coconut Tom Yum Dressing (VG)

Corn Fritters, Sour Chilli Sauce, Ginger, Pickled Daikon (V) (G)

Broccoli Bang Bang -Corn, Red Peppers, Radish, Sesame, Green Onion (VG)

Smoked Salmon Yum Woon Sen-Glass Noodles, Celery, Coriander, Chilli (S)

Green Papaya, Pickled Carrot, Kohlrabi, Herbs, Peanuts, Nuoc Cham (VG) (N)

Squid Black Pepper Noodles, Choy, Red Ginger (G) (S)

Nepalese Potato & Cauliflower Curry (VG)

Chicken Karaage, Korean Mustard Sauce, Green Onion

Eggplant Katsu, Tonkatsu Sauce, Kewpie, Curry Salt, Chives (V) (G) (D)

Steamed Tofu, Chilli Bean Soy, Cucumber Relish (VG) (G)

Pork Belly, Chilli Caramel, Apple Slaw, Black Vinegar

Beef Rendang, Coconut, Pickled Green Papaya

Slow Braised Goat, Black Pepper, Holy Basil, Crispy Garlic

Feel like something sweet? Add our Coconut Water Tapioca Dessert for \$10PP

All guests must select the same items.

Pre select your items 48 Hours prior to your event.

Credit Card surcharge of 1.4% and service charge of 8% applies to group bookings.

Private Dining Lunch Packages

\$60pp

(Excl. 8% Service Charge)

Appetiser On Arrival ~ Vegetarian Spring Rolls*

~

5-Dishes Of Your Choice, Shared Lunch Menu

\$70pp

(Excl. 8% Service Charge)

Welcome Drink On Arrival

- Nv Sole D'oz Prosecco

- Lychee Passion Mocktail

Appetiser On Arrival ~ Vegetarian Spring Rolls*

7-Dishes Of Your Choice, Shared Lunch Menu

Add A 1.5-Hour Classic Beverage Package For \$25pp

Check out our beverage package page below for current package options

*Appetiser is subject to change and do not cater replacement appetiser for dietaries.



Dinner Menu

Tuk Tuk Menu

\$88pp

Betel Leaf - Prawn, Lime, Coconut, Chilli, Lemongrass **S**

Corn, Green Onion, Cheese Croquette, Wasabi Mayo, Pistachio Furikake **N D V G**

Salmon Tartare, Yuzu Pickled Grape, Wasabi Soy, Chives, Crispy Potato **G**

Cauliflower Kung Pao, Cashews, Sichuan Pepper, Chilli, Green Onion **G N VG**

Rockling, Green Papaya, Herbs, Pickled Carrot, Nouc Cham

Chicken Red Curry, Pumpkin, Thai Basil

Pork Belly, Chilli Caramel, Apple Slaw, Black Vinegar

Passionfruit Pannacotta, Pandan Ice-Cream, Caramel Popcorn **D V**

Add a Prawn Dumpling on arrival for \$5PP

Please see below for Vegetarian options.

Please provide additional dietary requirements 48 hours prior to arrival.

Credit Card surcharge of 1.4% and service charge of 8% applies to group bookings.



Above: Corn, Green Onion, Cheese Croquette, Wasabi Mayo, Pistachio Furikake

Below: Pork Belly, Chilli Caramel, Black Vinegar & Apple Slaw

Dinner Menu

Songthaew (Thai Bus) Menu

\$115pp

Betel Leaf - Prawn, Lime, Coconut, Chilli, Lemongrass **S**
Corn, Green Onion, Cheese Croquette, Wasabi Mayo, Pistachio Furikake **N D V G**
Chicken, Bacon, Mozzarella Dumplings-Spicy Mushroom, Shallot Sauce **D G**
Steamed Scallop, Vietnamese Curry, Lemongrass, Pickled Chilli **S**

Bang Bang Chicken Salad, Sesame, Chilli, Green Onion, Cucumber
Tuna Tataki, Passionfruit & Green Chilli Nuoc Cham, Radish, Vietnamese Mint
Lamb Ribs, Ginger BBQ Sauce, Chilli, Sesame

Wagyu Beef Red Curry, Pumpkin, Snake Beans, Thai Basil
Pork Belly, Chilli Caramel, Apple Slaw, Black Vinegar

Yuzu Curd, Meringue, Coconut Ice-Cream, Tropical Fruit **D V**

Add a Prawn Dumpling on arrival for \$5PP

*Please see below for Vegetarian options.
Please provide additional dietary requirements 48 hours prior to arrival.
Credit Card surcharge of 1.4% and service charge of 8% applies to group bookings.*



Above: Lamb Ribs, Ginger Bbq Sauce, Green Onion
Below: Tuna Tartare, Wasabi Soy, Chives, Roe, Lemon Balm, Rice Paper

Tuk Tuk Menu

Vegetarian

\$88pp

Betel Leaf - Pineapple, Pumpkin Seeds, Coconut, Mint **VG**

Corn, Green Onion, Cheese Croquette, Wasabi Mayo, Pistachio Furikake **N D V G**

Radish Cake, Avocado, Soy Roasted Pumpkin, Miso, Lemon Balm **VG**

Cauliflower Kung Pao, Cashews, Sichuan Pepper, Chilli, Green Onion **N VG G**

Broccolini Bang Bang - Cucumber, Baby Corn, Mushroom, Sesame **VG**

Crispy Eggplant, Peanuts, Sesame, Pickled Carrot, Coriander, Hot 'n' Sour Sauce **VG G**

Tofu, Roasted Pumpkin, Snake Bean, Tomato Red Curry **VG**

Passionfruit Pannacotta, Pandan Ice-Cream, Caramel Popcorn **D V**

Add a Vegetarian Springroll on arrival for \$5PP

*Please provide additional dietary requirements 48 hours prior to arrival.
Credit Card surcharge of 1.4% and service charge of 8% applies to group bookings.*



Above: Grilled Daikon Cake, Shimeji XO, Cucumber, Red Radish, Black Sesame



Below: Crispy Tofu, Cucumber Pickle, Satay Sauce, Coconut, Coriander

Songthaew (Thai Bus) Menu

Vegetarian

\$115pp

Betel Leaf - Pineapple, Pumpkin Seeds, Coconut, Mint **VG**

Corn, Green Onion, Cheese Croquette, Wasabi Mayo, Pistachio Furikake **N D V G**

Radish Cake, Avocado, Soy Roasted Pumpkin, Miso, Lemon Balm **VG**

Mushroom XO, Red Radish, Sichuan Cucumber, Crispy Potato Cake, **G VG**

Cauliflower Kung Pao, Cashews, Sichuan Pepper, Chilli, Green Onion **N G VG**

Broccolini Bang Bang - Cucumber, Baby Corn, Mushroom, Sesame **VG**

Green Papaya, Pickled Carrot, Kohlrabi, Peanut, Herb Salad **VG N**

Crispy Eggplant, Peanuts, Sesame, Pickled Carrot, Coriander, Hot'n'Sour Sauce **N G VG**

Tofu, Roasted Pumpkin, Snake Bean, Tomato Red Curry **VG**

Yuzu Curd, Meringue, Coconut Ice-Cream, Tropical Fruit **D V**

Add a Vegetarian Springroll on arrival for \$5PP

*Please provide additional dietary requirements 48 hours prior to arrival.
Credit Card surcharge of 1.4% and service charge of 8% applies to group bookings.*



Above: Corn Ribs, Gochujang Butter, Queso Fresco
Below: Green Papaya, Pickled Carrot, Kohlrabi, Herbs, Chilli, Peanuts



'Go The Extra Mile'

\$200PP

This is your chance to savor innovative dishes crafted by our Executive Chef John McLeay. Take a 10 course menu, customised for each event utilising seasonal ingredients and surprising flavor combinations—an unforgettable dining experience awaits!

Our renowned Pork Belly with Chilli Caramel, is a permanent fixture on this exclusive menu.

Please note that this unique dining experience is available exclusively in our private dining room for groups of up to 30 guests.

Don't miss out on this culinary journey at Red Spice Road—it promises to be a memorable dining adventure!

We'll be delighted to offer custom wine pairings to complement your meal, please speak to our staff to find out more information.

*Please provide additional dietary requirements 48 hours prior to arrival.
Credit Card surcharge of 1.4% and service charge of 8% applies to group bookings.*





Classic Beverage Package

2 HOURS \$42pp | 3 HOURS \$55pp | 4 HOURS \$70pp

Wines

White

2023 Version 2, Pinot Grigio (South Eastern Australia)

Red

2013 Massoni Sangiovese (Pyrenees, VIC)

Beer

Asahi Lager (5% ABV)
Asahi Soukai (3.5% ABV)

Non Alcoholic

Soft Drinks
Sparkling Water

Start your event with a Spark! Speak to our team about drinks on arrival, custom packages and more.

*Beverage packages are only available for groups in private dining rooms.
Drinks are subject to change, we will inform you of a replacement if necessary at the time of booking.*

Premium Beverage Package

2 HOURS \$55pp | 3 HOURS \$70pp | 4 HOURS \$85pp

Wines

Sparkling

NV Sole D'Oz Prosecco (Victoria)

White

2023 Version 2, Pinot Grigio (South Eastern Australia)

2024 Reschke 'Bull Trader' Chardonnay (Limestone Coast, SA)

Red

2013 Massoni Sangiovese (Pyrenees, VIC)
2022 Yoru Pinot Noir (Mornington Peninsula, VIC)

Beer

Asahi Lager (5% ABV)
Asahi Soukai (3.5% ABV)

Non Alcoholic

Soft Drinks
Sparkling Water

Canape Functions

For groups of over 60PAX, we offer 7 canape items plus Beverage Package combinations.

Menu Items - \$75PP

Prawn Har Gow, Chilli, Black Vinegar Soy **G S**

Crispy 5 Spice Pork Belly, Chilli Caramel

Chicken Karaage, Honey Mustard Sauce

Korean Beef Skewers, Sesame, Green Onion **G**

Chickpea & Potato Curry Pie, Tomato Kusundi **VG**

Corn & Green Onion Croquette, Wasabi Mayo **V D**

Vegetable Spring Rolls, Lettuce, Herbs, Nuoc Cham **V G**

Beverage Packages

Please see page above for more details

Classic **2 HRS \$42pp | 3 HRS \$55pp | 4 HRS \$70pp**

2 Wines, 2 Beers, Soft Drinks & Sparkling Water

Premium **2 HRS \$55pp | 3 HRS \$70pp | 4 HRS \$85pp**

4 Wines (Incl Prosecco), 2 Beers, Soft Drinks & Sparkling Water

Please provide additional dietary requirements 48 hours prior to arrival.

Credit Card surcharge of 1.4% and service charge of 8% applies to group bookings.



Event Add Ons

We are happy to offer AV solutions for your event.

We are able to provide the following items for a cost of;

Microphone & Speaker: \$100

Projector & Screen: \$75

Get Floral!

Embrace the beauty of blooms and infuse some floral charm to your function!

Provide your preference to our event team and we will help you find the perfect fit for your occasion.





Frequently Asked Questions

What are the costs involved?

Enjoy exclusive areas with no room hire fee! A deposit of a fixed amount by number of guests will be required and you will be required to meet a food and beverage minimum spend.

Prices will vary depending on the area, time and date of booking.

Our Deposit Policy as;

<i>Lunch</i>	<i>12 - 20 PAX - \$200</i>
<i>Lunch</i>	<i>20 - 30 PAX - \$500</i>
<i>Lunch</i>	<i>30 - 50 PAX - \$1000</i>
<i>Dinner</i>	<i>12 - 20 PAX - \$500</i>
<i>Dinner</i>	<i>20 - 30 PAX - \$1000</i>
<i>Dinner</i>	<i>30 - 50 PAX - \$2000</i>

Venue bookouts and events over 50 persons and above will have a deposit based on 25% of their minimum spending.

What are your operating days?

You can book your function with us;
Tuesday to Friday: Lunch and Dinner
Saturday: Dinner

We do consider functions on any day for large groups.

Can we split the bill?

Unfortunately we do not allow split payment for private dining rooms.

Do you have a surcharge?

A surcharge of 1.4% will apply to all card payments. We also apply a service charge of 8% for bookings over 8 people.

Are children welcome and do you have high chairs?

Children are more than welcome but must be accompanied by an adult at all times. We have limited highchairs and do our best to accommodate all requests but cannot guarantee them. We have limited options for children, please enquire for more information.

Can we bring a cake?

You are more than welcome to bring along a cake. This can be delivered to the venue on the day of your event. We have a cakeage charge of \$2 per person.

Do we have to choose a set menu?

All functions need to choose a set menu and pre-order at the time of booking. All party members need to choose the same menu/dishes. We offer a great range of options to suit your budget. Most dietary requirements can be accommodated.

Do you provide any extra services?

You can hire AV equipment from Red Spice Road.
Microphone & Speaker: \$100
Projector & Screen: \$75

Flowers, balloons and custom menus can all be arranged on request, pricing will vary.



Frequently Asked Questions

Can you cater for dietary requirements?

We are happy to cater for most dietary requirements given at least 48 hours notice.

Dining on a set menu, any vegetarian, pescatarian and gluten-free diners will receive their own set menu at the same charge per person. More restrictive food requirements such as allergies will receive one dish per course depending on the severity.

We regret we cannot accommodate paleo diets or any dietary requirements relating to any staple Asian ingredients (e.g. chilli, lemongrass, coriander). These are included in all base sauces, marinades, dressings and condiments, and are difficult to exclude from our dishes.

If you have any queries, please get in touch and we will do our best to accommodate.

When do you need everything finalised by?

We will require the deposit within 48 hours of making a booking.

Final choice of the menu and all dietary requirements are due 48 hours before your event.

No Show Policy

If your booking number drops within 24 hours you will be charged for the original amount of covers that you booked for. Changes to your booking can be made in advance by contacting our team.

What if I cancel?

We understand that plans change. Please see our cancellation policy below:

Cancellation by the client must be received in writing and be acknowledged by the venue. Where the client to cancel the agreed services:

More than 60 days prior to the services date, the venue will refund all deposits/ amounts paid

Between 60 days and 72 hours prior to the scheduled services date, the deposit amount will be retained by the venue but can be transferred for a future event at any venue and used within 6 months.

Less than 72 hours prior to scheduled services date, the venue retains all deposit amount(s) and the client agrees to pay 100% of the outstanding agreed minimum spend.

For a full list of terms and conditions, visit redspiceroad.com/conditions



Accessibility

The entrance of the restaurant is located at 141 Queen St, Melbourne.

Assisted Access

The alternate entrance is located via 131 Queen st, Melbourne, where a lift will lead you to the restaurant located on the Upper Ground floor.

The venue is equipped with an accesible bathroom on the upper ground floor.

Persons with disabilities will be assisted into the restaurant with staff, and can be reached through an intercom located at the front entrance.

Transport

The restaurant is accessible via the tram route 86 and 96 – stop 4 (Queen St/ Bourke St)

Wilson Parking available on Bourke St near McDonalds.

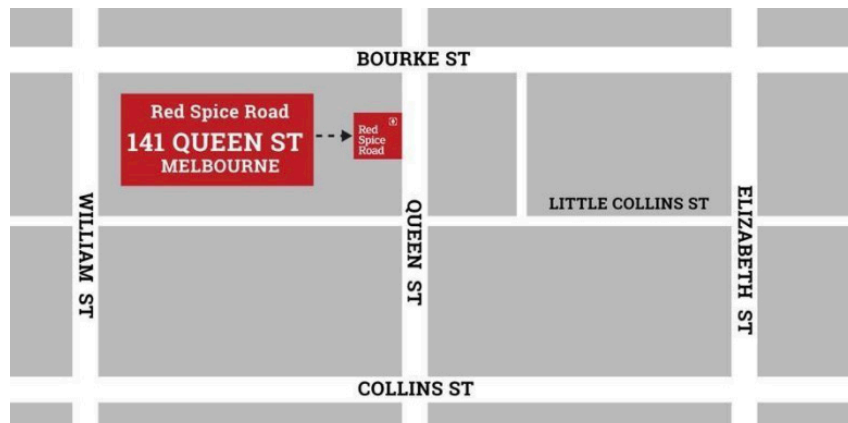

Contact Us

Feeling overwhelmed? Don't panic, our events team would love to help you decide which of our spaces and menu options suit you best.

141 Queen Street, Melbourne

Phone Number: (03) 9603 1601

Email Address: info@redspiceroad.com

Website: RedSpiceRoad.com

Follow us!

<https://www.instagram.com/redspiceroad/?hl=en>

<https://www.facebook.com/redspiceroad/>

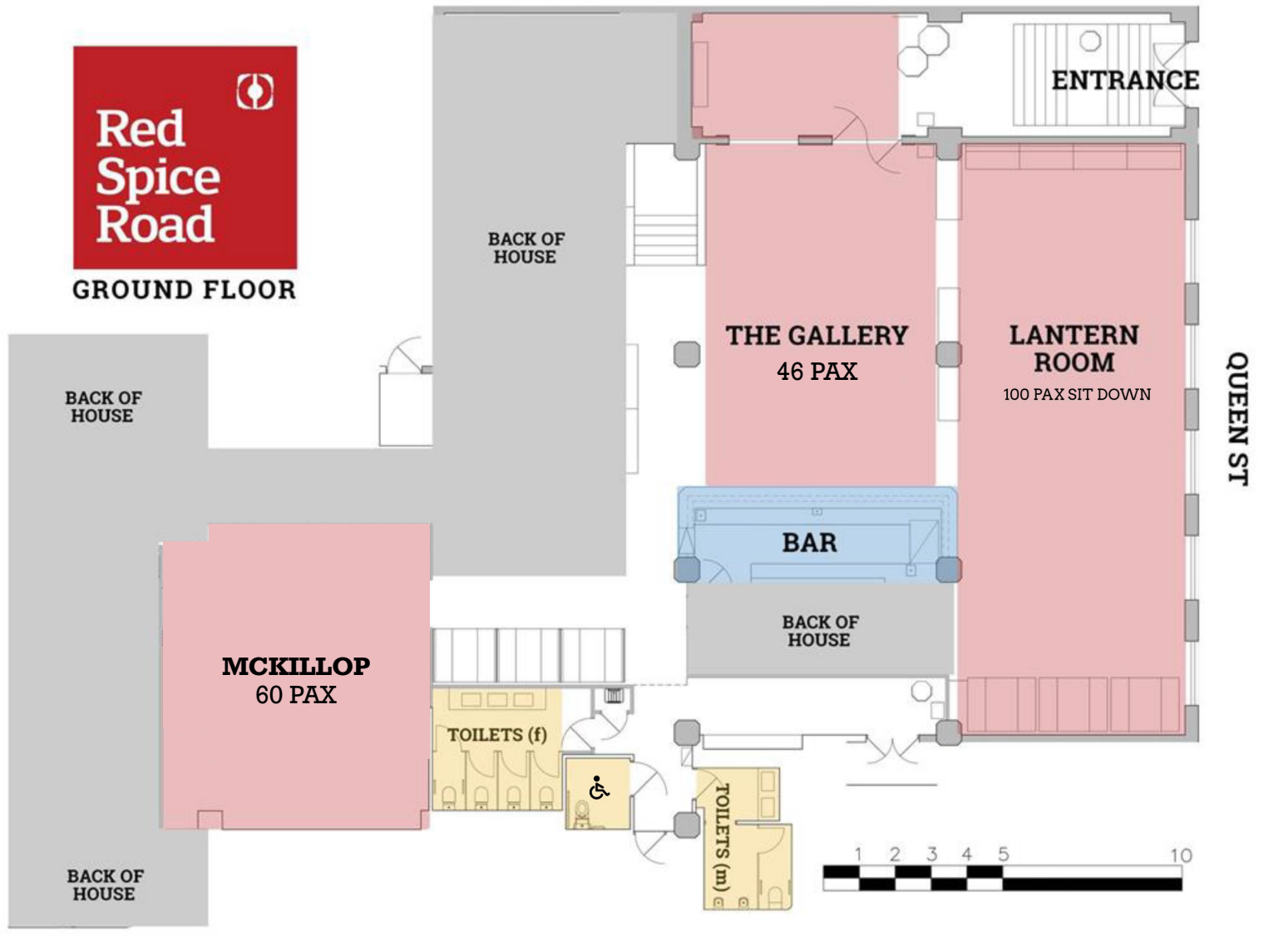

Please note, all private dining rooms will require a minimum spend that will be excluding an 8% service charge.

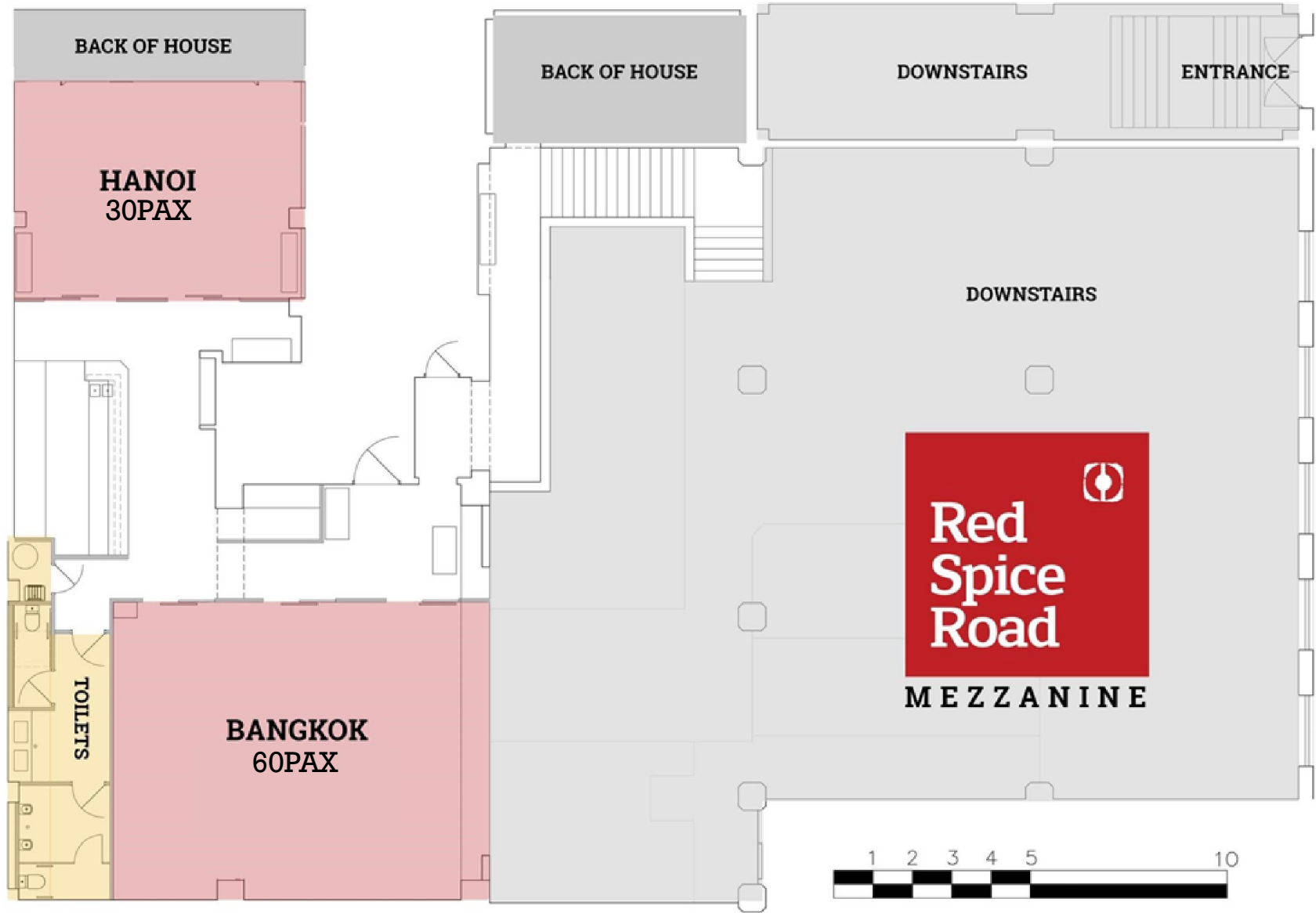

Please note, all private dining rooms will require a minimum spend that will be excluding an 8% service charge.